

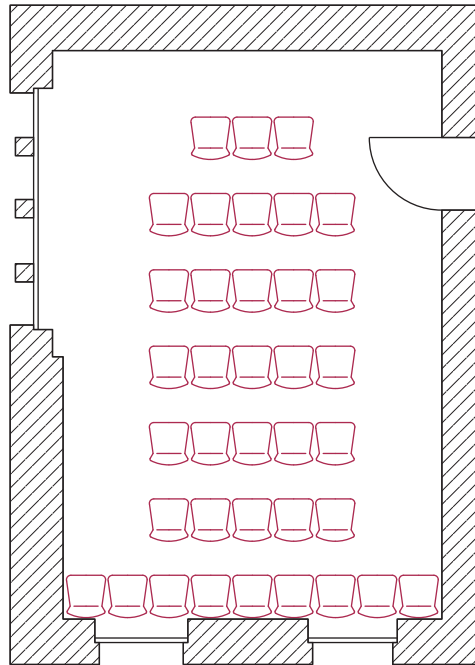

Bestuhlungsplan Salon Levy

Reihenbestuhlung | 37 Personen



Richtung Goerke,
Verbindungsgang Hotel

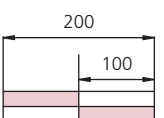



Bestuhlungsplan Salon Levy

Parlamentarische Bestuhlung | 22 Personen

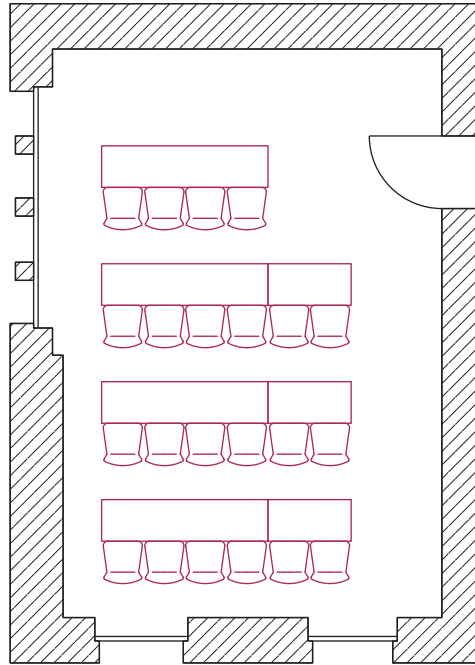

Richtung Goerke,
Verbindungsgang Hotel

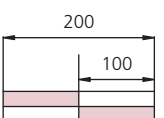



Bestuhlungsplan Salon Levy

Bankettbestuhlung 55er-Tische | 36 Personen

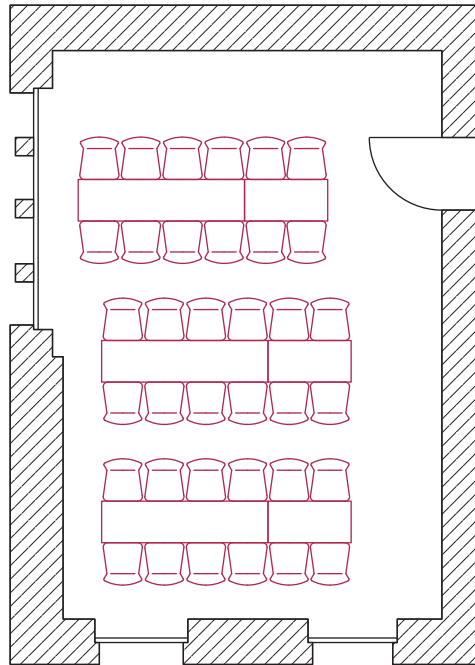

Richtung Goerke,
Verbindungsgang Hotel

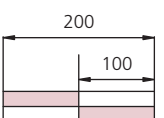



Bestuhlungsplan Salon Levy

Blockbestuhlung | 24 Personen

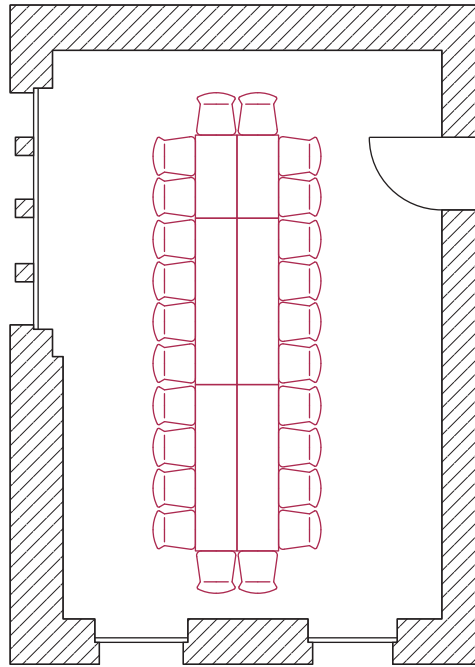

Richtung Goerke,
Verbindungsgang Hotel

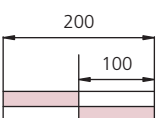



Bestuhlungsplan Salon Levy

U-Form Bestuhlung | 20 Personen

